

Job:

Approval:

Type:

VISION 3

LIGHTING

LED Dual Sign Light **MODEL SL7**
120-277V, 15W Max. ea., Dual Integral Driver COB LED
30W Max. ea., Dual COB LED (Remote Drivers Required)

Specifications

Material

Machined 6061-T6 aluminum with 18-8 stainless steel hardware.

Head

Machined heads come in two styles: Side Mount and Rear Mount. (See illustration for aiming capabilities of each head.)

Stem

1" diameter machined stem comes in various stem lengths and three stem styles: Straight, 180° U-Bend, and 90° Gooseneck. (See illustration for calculating overall projection from wall for each stem style.)

Knuckle

A Rotate and Lock knuckle (protected under U.S. Patents #6,966,679, #7,108,405 and #7,458,552) mounts each head and allows for adjustability. Double taper design allows fixture to hold position during aiming and ensures a solid lock when tightened. Molded silicone wire compression seals at knuckles prevent water entry around wires.

Cap

Machined caps come in seven styles, lock in place with one 18-8 stainless steel set screw, and are sealed to the body with a high temperature silicone O-ring. Regress Lens caps have drain holes for water drainage from top of lens if mounted in the up position. All caps accept two internal accessories, held in place by a stainless steel clip.

Mount Canopy

Integral Driver COB LED available with the following mount options: MO3 (Machined Round Canopy), MO15 (Machined Square Canopy), and MO12 & MO13 (Surface Mount Canopies). Remote Driver COB LED available with MO13 only. Stem is permanently attached to mount canopy using a 304 stainless steel threaded nipple to prevent loosening or sagging. See mount specification sheets for more information. (Mount canopy must be mounted to an appropriate wall or junction box, in such a manner that is capable of holding the weight and torque created by the fixture. Junction box and hardware not included).

Finish

TGIC thermo set polyester powder coat paint available in 14 standard colors. Finish is applied over a corrosion resistant, hexavalent chromium free, RoHS compliant coating. Also available in one additional metal finish: Clear Anodized.

Lens

Each cap contains a 1/8" thick tempered, clear lens, secured with a high temperature, UV curing, silicone adhesive.

Light Engines⁶

Both COB LED light engine options use industry standard replaceable components and quick disconnects for ease of field maintenance and future upgrades, and includes features like: field changeable optics (15°, 24°, 36°, 55°, 65°), choice of color temperature (2700K, 3000K, 3500K, 4000K), CRI (80, 90), and an L70 > 50,000 hrs.

Integral Driver COB LED option: Each head includes a field replaceable driver module with a 350mA, 15W max Class 2 driver for features like: 1600lm max. nominal output, 105 lm/W efficacy, 120-277VAC (50/60Hz) input, programmable tri-dimming (TRIAC, ELV, 0-10V) down to 1%, and various protection features (input over current, short circuit and over current, internal over temperature, output open load). Notes: driver can be programmed for dimming profile or lower lumen output. Contact V3 for info. For compatible dimmers, see Compatible Dimmer list.

Remote Driver COB LED option: Requires Vision3 approved constant current dual driver mount (specified below). Includes performance of 1800lm @ 350mA, 2400lm @ 500mA, or 3200lm @ 700mA (values for each head). Note: see specification sheet of driver mount for appropriate driver ratings.

Certification

CSA tested & certified to US and Canadian safety standards for wet location wall mount use per UL1598 (Must be mounted in such a manner to properly support the fixture).

All ratings subject to change without notice. See web site or contact V3 for most current info.

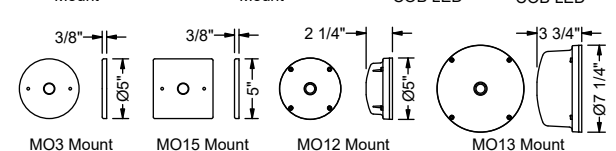
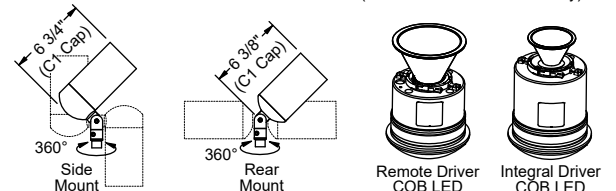
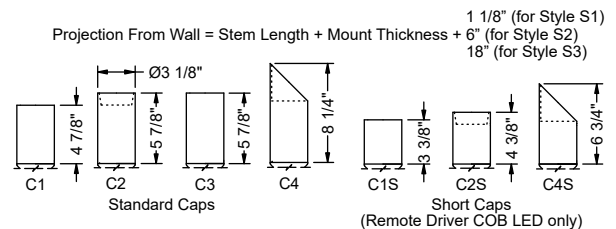
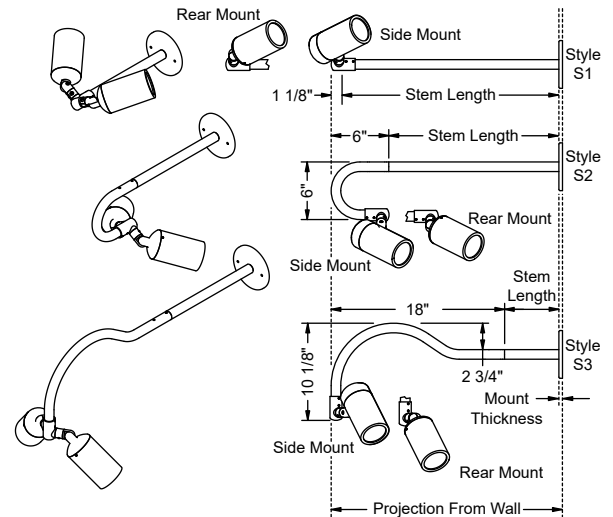

Ordering Information

SL7A									
Model	Finish	Head	Cap Style ⁵	Stem ²	Mount ^{3,4}	Light Engine ⁵	Lens Accy ⁵	Louver ⁵	
SL7A		SM - Side Mount RM - Rear Mount	Standard Caps: C1 - Flush C2 - Regress Lens C3 - Regress Lamp C4 - 45° Angled Short Caps ¹ : C1S - Flush C2S - Regress Lens C4S - 45° Angled	6 - 6" 12 - 12" 18 - 18" 24 - 24"	MO3 - Round Canopy MO15 - Square Canopy MO12 - Surface Mount Canopy MO13 - Surface Mount Canopy	LED ⁴ Integral Driver COB LED: LE1-1600 - 15W, 1600lm ⁶ LE1-1200 - 11W, 1200lm ⁶ Remote Driver COB LED: C01 - Remote Driver COB LED	0 - None L1 - Spread L2 - Linear L3 - Softening	0 - None H1 - Hex	
	Powder Coat Finishes: BLT - Textured Black BNT - Textured Bronze BAT - Textured Bark GRT - Textured Green GNT - Textured Granite SAT - Textured Sand PAT - Textured Patina EAT - Textured Earth Metal Finishes: CLA - Clear Anodized	BL - Black BN - Bronze WI - White SI - Silver GY - Grey BE - Beige	Style S1 - Straight S2 - 180° U-Bend (12" to 36" Stem only) S3 - 90° Gooseneck (24" max. Stem)		Remote Driver COB LED light engines only: MO13-2X15-UNV-350-TRI - Dual 15W max., 120-277V, 350mA MO13-2X30-UNV-500-TRI - Dual 30W max., 120-277V, 500mA MO13-2X30-UNV-700-TRI - Dual 30W max., 120-277V, 700mA	CRI 8 - >80 9 - >90 CCT 27 - 2700K 30 - 3000K 35 - 3500K 40 - 4000K Optics 15 - 15° 24 - 24° 36 - 36° 55 - 55° 65 - 65°			

Notes:

- Short cap options only available with Remote Driver COB LED options.
- Other stem lengths are available upon request. Contact Vision3.
- See mount specification sheet for mount details.
- Mount type must match Light Engine LED type.
- Cap Style, Light Engine, Lens Accy, and Louver options specified will be used for each head. To use different options for each head, contact Vision3.
- All lumen values cited are nominal lumen output (ideal lumen output of light engine only in lab conditions). Actual fixture output will vary with cap type, material, lens/optics options, and environmental conditions. For more accurate information, see fixture photometry files on website.
- Specifications, certifications, and ordering information are subject to change. Please check website for latest specification sheets.

Example: SL7A - BN - SM - C1S - S3 - 6 - MO13-2X30-UNV-500-TRI - C01-8-30-25 - 0 - 0